

HONDA

INSTALLATION INSTRUCTIONS

Accessory

SEAT COWL
P/N 08F76-MJW-J00

Application

CB500FA
CBR500RA

Publication No.

MII

Issue Date

September 2018

Honda Dealer: Please give a copy of these instructions to your customer.

PARTS LIST

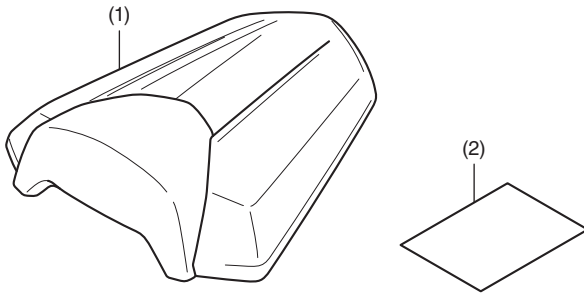

| No. | Description | Qty |
|-----|-------------|-----|
| (1) | Seat cowl | 1 |
| (2) | URL paper | 1 |

INSTALLATION

▲ CAUTION

- To prevent burns, allow the engine, exhaust system, radiator, etc., to cool before installing the accessory.

- Remove the pillion seat as shown.

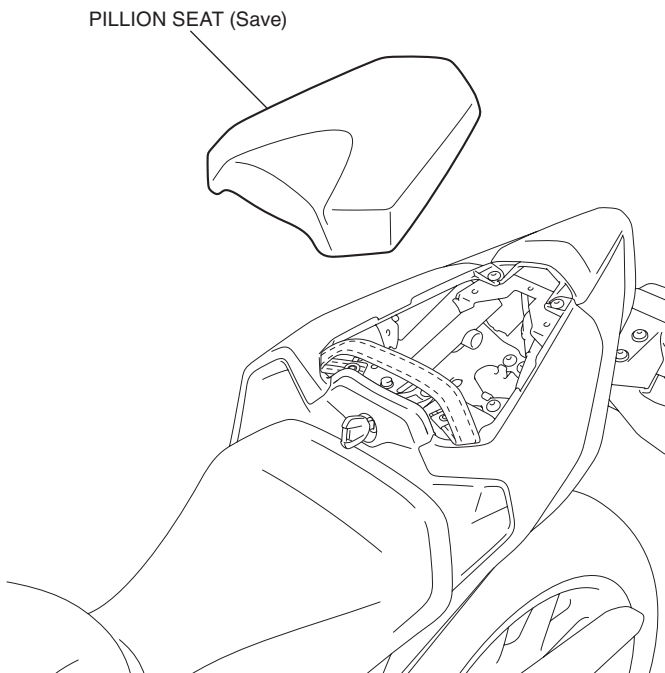

- Remove the belt as shown.

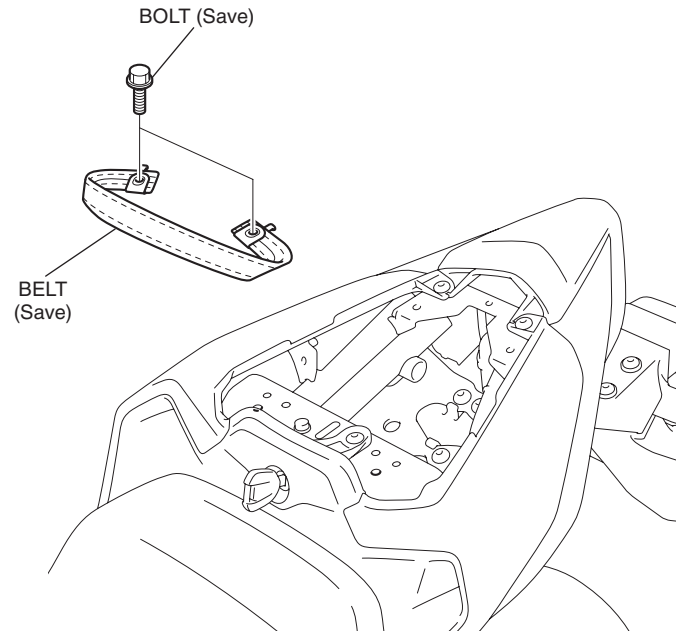

- Install the seat cowl as shown.

- Insert the hook, and then press down the front side of seat cowl to install.
- After installing, check that the seat cowl is locked securely. Failure to lock the seat cowl securely may cause it to fall off while riding.

